

Ready Sill Window Pan® Suggested Installation and Use Details

Additional materials by the **Henry / Fortifiber Company**
This product is covered by the **Fortifiber 1-2-3 Moisture Control System** 15 year warranty.

1. These drawings depict a patented window and door pan system developed by:

TLS Laboratories

27324 Camino Capistrano #103

Laguna Niguel, CA 92677

800-310-7673

949-348-9291

They may be purchased at **www.TLSLabs.com** or at **selected distributors.**

www.TLSLabs.com

info@TLSLabs.com

Additional materials shown are by the Henry / Fortifiber Corporation.

2. It is important to verify the window manufacturer's installation instructions, if any exist. They will take precedence if a conflict arises.

3. Rough openings should be no less than 1/2" greater in width and height than the net frame size of the window.

4. Rough openings to be level, square and plumb.

5. Tradesmen /DIY'ers are expected to be proficient in the use of power tools and safety equipment.

6. **WANED LUMBER SHOULD NOT BE USED @ ROUGH OPENINGS LOCATIONS.**

Ready Sill Window Pan
End Dam Supplied is
placed on top of the
GS100A.

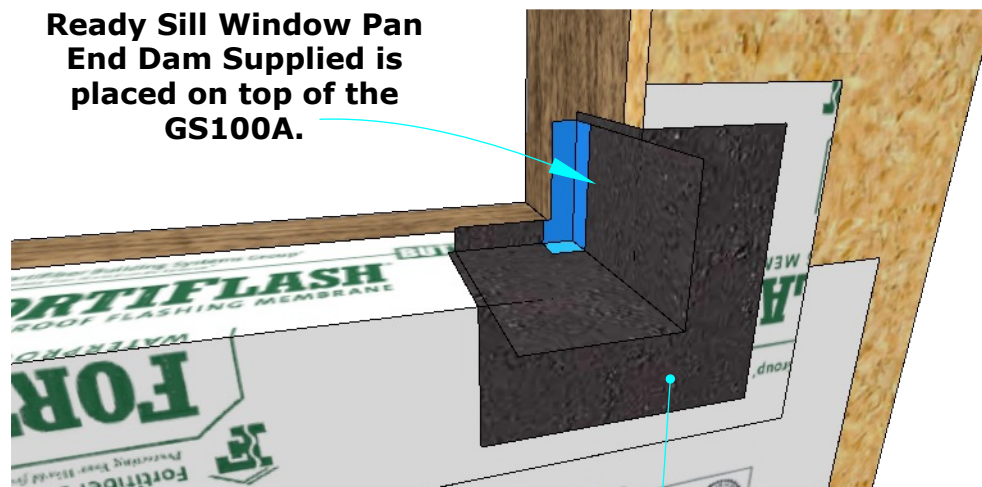

GS100 "A" Piece
Supplied

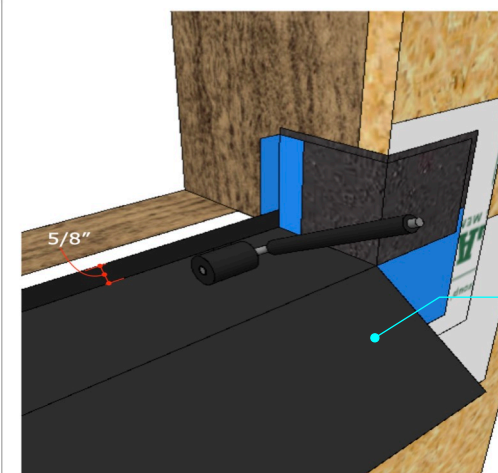

Ready Sill Insert
Supplied

ANY CUSTOM SIZE NOW AVAILABLE. CALL 1.800.310.7673 FOR PRICING.

Henry
Building Confidence

Ready Sill® Window Pan System



800.310.7673
949.348.9291
info@TLSLabs.com
www.tslslabs.com

STEP 1

Prepare the rough opening

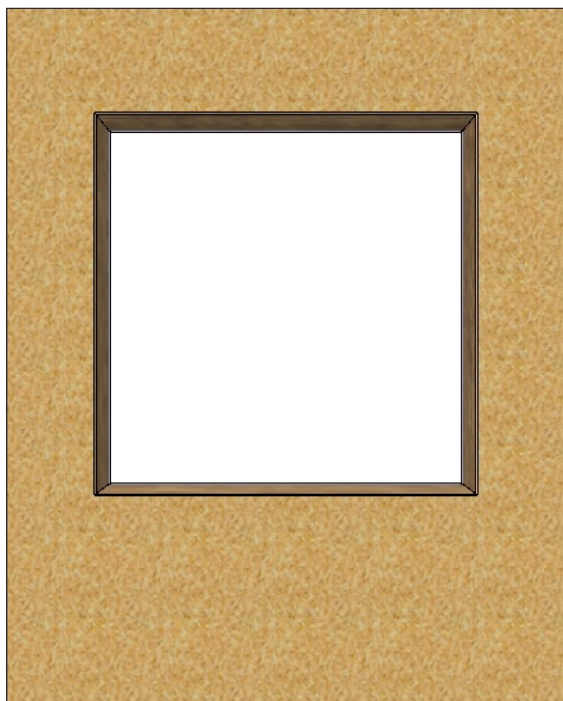

NOTE:

RO should be **NO LESS** than 1/2" greater in width and height than the net frame size of the window.

STEP 2

Add the apron

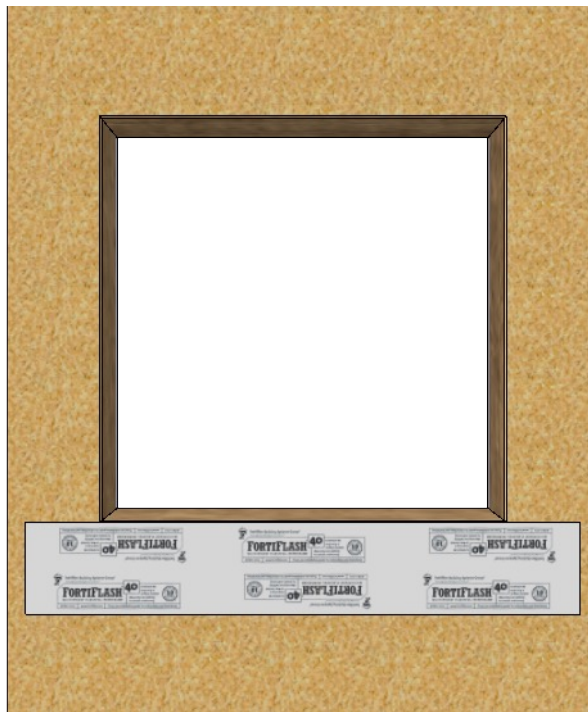

NOTE:

The use of **Fortiflash®** or **Moistop®** products is suggested. Leave loose at the bottom edge so the subsequent layers of building envelope may be tucked under. 12" **Fortiflash®** is shown above.

STEP 3

Optional Step: Add SAF membrane as shown

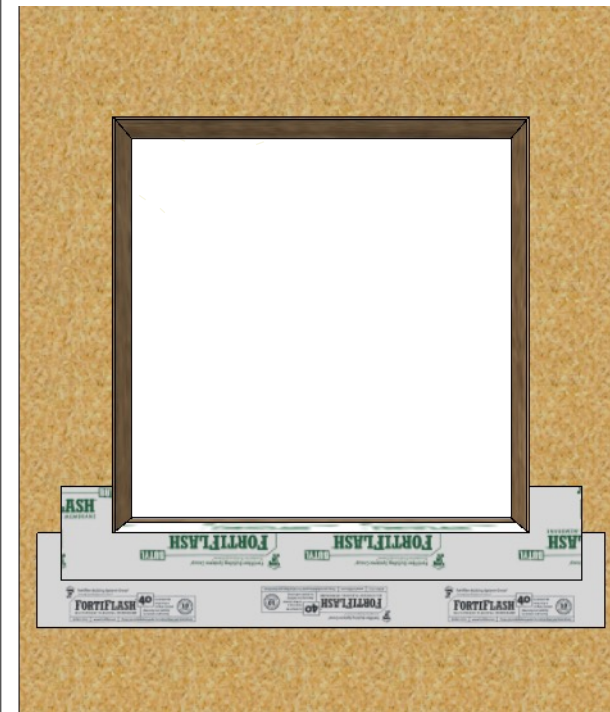

NOTE:

The use of **Fortiflash®** SAF materials is suggested here. This step is not required, but we consider it appropriate. 12" **Fortiflash®** is shown above.

STEP 4

Apply Moistop Sealant® as shown



NOTE:

Moistop Sealant® should be applied as shown. Use 3/8"-1/2" bead size. Use a round tubular shaped bead, not a ribbon shaped flat bead of sealant.

STEP 5

Apply the Corner Flash® GS 100 A piece as shown.



NOTE:

Press the **Corner Flash® GS 100 "A"** piece into the wet **Moistop Sealant®** and J-Roller flat, ensuring complete adhesion to the substrate.

STEP 6

Apply Moistop Sealant® as shown.



NOTE:

Moistop Sealant® should be applied as shown. Use 3/8"-1/2" bead size. Use a round tubular shaped bead, not a ribbon shaped flat bead of sealant.

STEP 7

Apply the Ready Sill® End Dam pieces as shown.

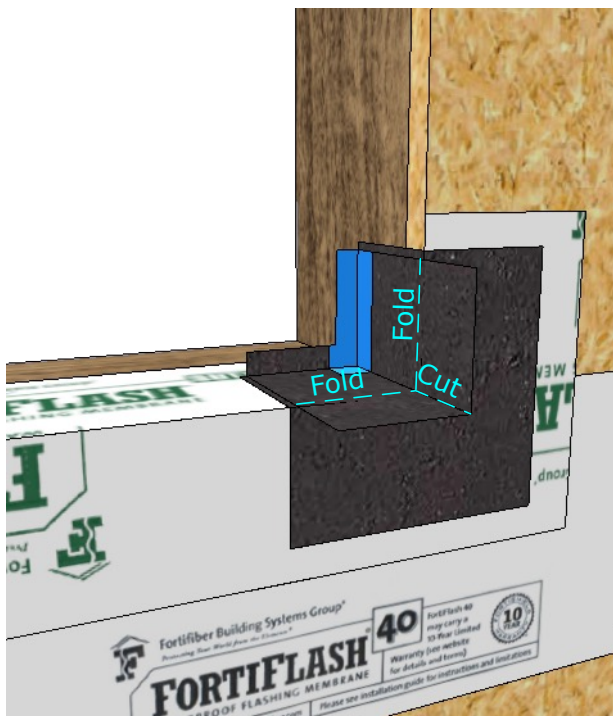

NOTE:

The **Ready Sill®** End Dam should be pressed into the wet **Moistop Sealant®** and J-Rolled into place. Place the **Ready Sill®** End Dam in the correct location based upon the window size you are using. Place the inside lip of the end dam so that it will be 1/8" back from the inside edge of the window. See steps 14 and 15 for clarity.

STEP 8

Cut and fold the Ready Sill® End Dam as shown

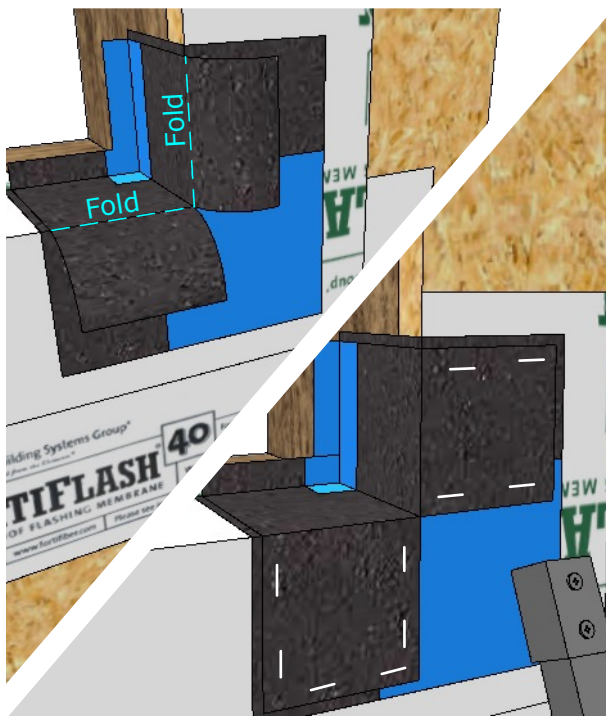

NOTE:

Cut and fold the **Ready Sill®** End Dam as shown in the drawing above. Secure in place with staples.

STEP 9

Apply Moistop Sealant® as shown.

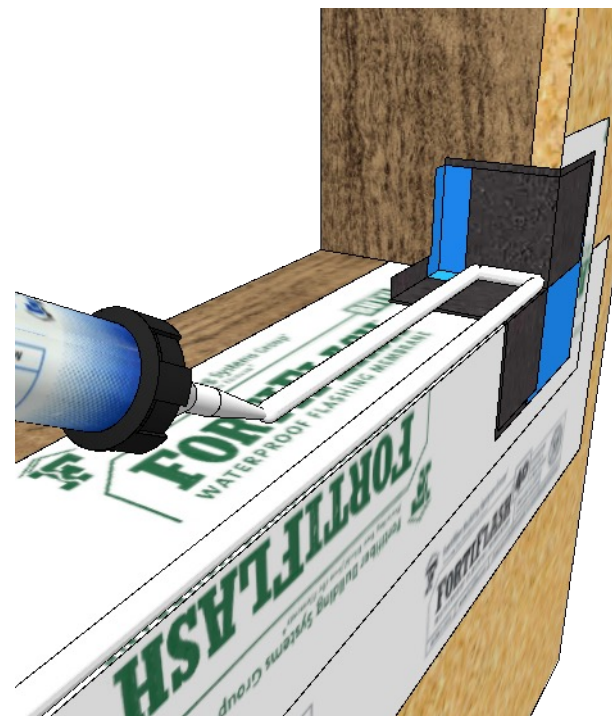

NOTE:

Moistop Sealant® should be applied as shown. Use 3/8"-1/2" bead size. Use a round tubular shaped bead, not a ribbon shaped flat bead of sealant.

STEP 10

Press the Ready Sill® Insert into place.

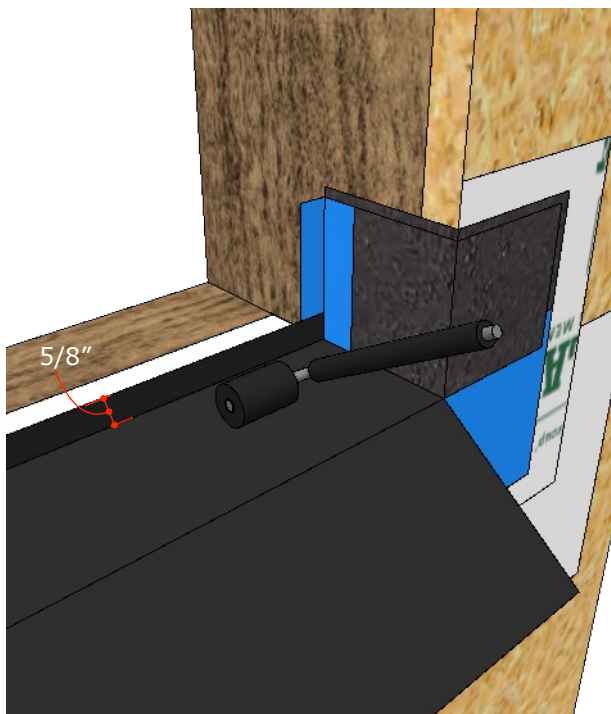

NOTE:

Cut the **Ready Sill®** Insert to fit your rough opening width and press into the wet **Moistop Sealant®**.
Always J-Roll the material flat.

STEP 11

Apply Fortiflash® SAF side flashing as shown.

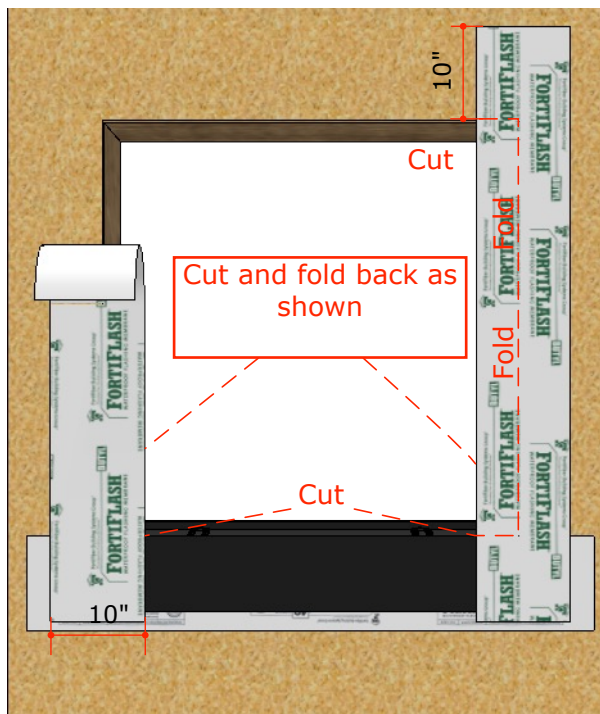

NOTE:

We suggest the use of **Fortiflash®** 9" or 12" width material so that it may be applied as shown above.
12" **Fortiflash®** is shown above.

STEP 12

Apply Fortiflash® SAF side flashing as shown.

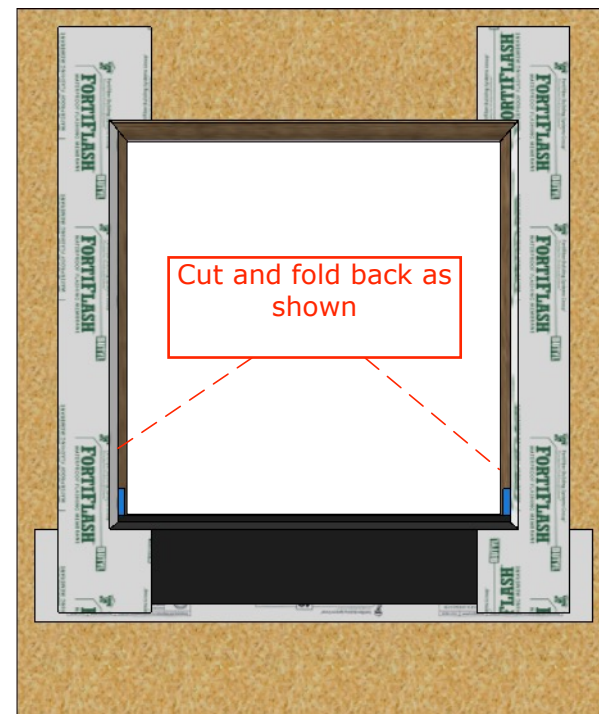

NOTE:

We suggest the use of **Fortiflash®** 9" or 12" width material so that it may be applied as shown above.
12" **Fortiflash®** is shown above.

STEP 13

Apply plastic shims as shown

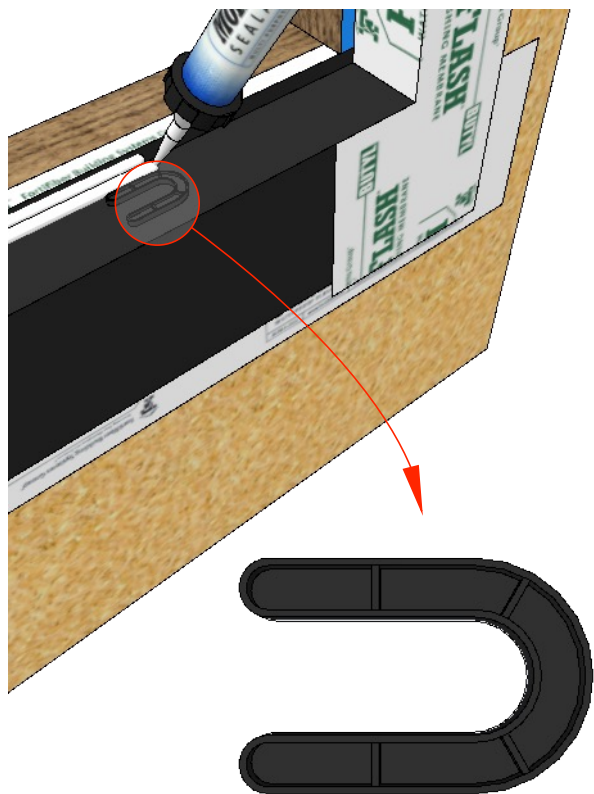

NOTE:

We suggest the use of plastic horseshoe shims under the window. Use 1/16"-1/4" inch thickness and shim the window level. Lay shims with 4"-6" spacing between shims.

STEP 14

Set the window in the rough opening and secure into place.



NOTE:

Place the window so that it sits 1/8" inside the lip of the **Ready Sill®** Pan Insert. Ensure the window is level, square and plumb.

STEP 15

Position the window correctly inside the Ready Sill® Pan.

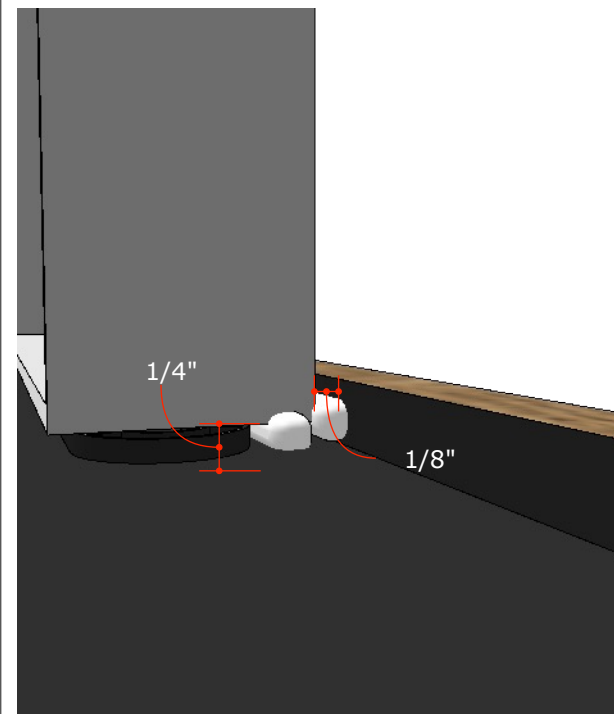

NOTE:

Place the window so that it sits 1/8" inside the lip of the **Ready Sill®** Pan Insert. Ensure the window is level, square and plumb.

ALL DONE!

Simply apply a top course
flashing
to finish the assembly.

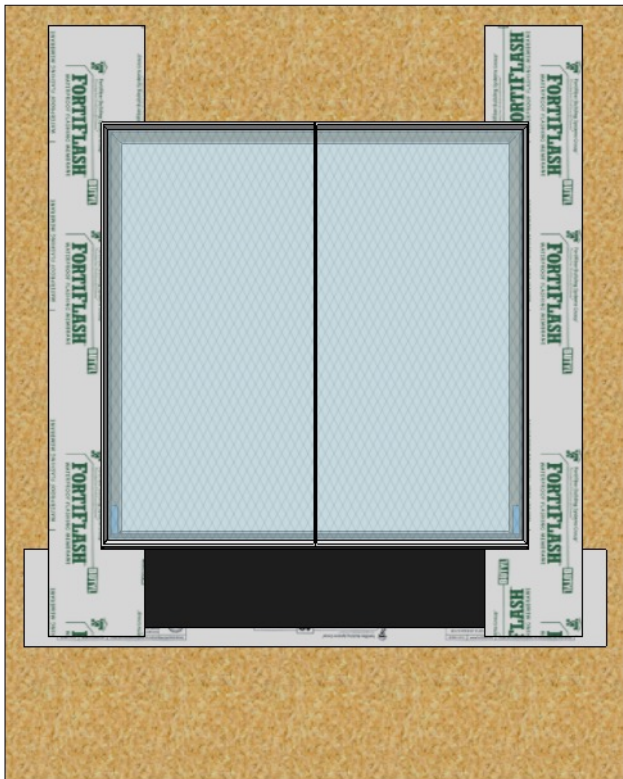

NOTE:

NOTE:

NOTE:

Apply a top course of top flashing to
complete the assembly.
We suggest the use of **Fortiflash®** SAF.
We especially like 12" **Fortiflash® Butyl**.